



INSTRUCTION MANUAL

PRECAUTIONS BEFORE BATTERY USE

Chargers and charging

- Do not overcharge the batteries. When the batteries are fully charged, please unplug the charger.
- After charging is over, please do not recharge the batteries so as to avoid overheating.
- Do not charge the batteries near flammable materials or on the surface of flammable (carpet, wooden floor, solid wood furniture, etc.) or conductive objects, and observe the batteries at any time.
- Do not charge the batteries immediately while they are still hot after use.
- The temperature of the batteries should be between 0°C and 40°C.
- Please unplug the charger when the batteries are not being charged.

Use and Storage

- It is strictly forbidden to pack damaged batteries with plastics.
- Do not insert or remove the batteries when the product is in use.
- Do not expose the batteries to excessive physical impact.
- It is strictly forbidden to use expanded, leaked or broken batteries or those emitting peculiar smell.
- Children are forbidden from touching the batteries.
- Do not put the batteries in the fire to avoid contact between the batteries and liquid. It is strictly forbidden to get the product wet in the rain or place it in a damp place.
- Do not put the batteries in a microwave oven or a pressure tank.
- Do not disassemble, drill, deform or cut the batteries. It is strictly forbidden to carry heavy objects on batteries or chargers or knock the batteries.
- Do not clean the charger with solvents, industrial alcohol or other flammable solvents.
- Be cautious about short circuit. Avoid direct contact with electrolytic substances in batteries.
- Electrolytic substances and electrolytic steams are harmful to the body.
- Store the product in a greenhouse. Do not expose the product to extreme temperatures.
- Avoid substantial changes in the temperature of the place where the product is stored.
- Do not place the product near the accessories of heating source.
- The batteries should be taken out when the product is not in use.



This device complies with part 15 of the FCC Rules. Operation is subject to the following two conditions: (1) This device may not cause harmful interference, and (2) this device must accept any interference received including interference that may cause undesired operation.

FCC ID: 2AZUH-F6BC

REMOTE CONTROL AND CAR

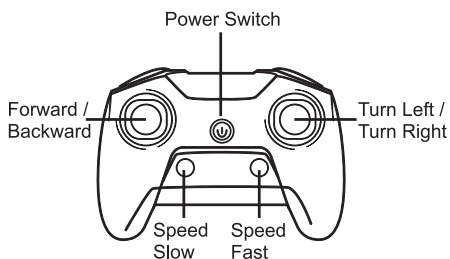

3XAAA batteries for Remote Controller
(Not included)

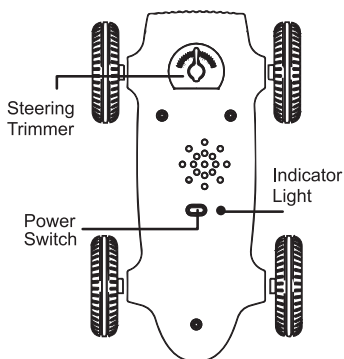

1. Press and hold the power switch to turn on the remote control, when the indicator light is on, indicate that the codes are synchronized, the car is ready for use.

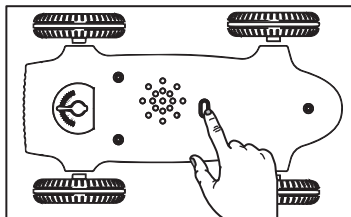

2. Press and hold the power switch for about one second to turn on the car. The indicator light will flash during this time, signaling that the car is pairing with the remote.

TRIMMER AND CALIBRATION

If the car drifts left, adjust the trimmer button to the right until it drives straight.

If the car drifts right, adjust the trimmer button to the left until it drives straight.

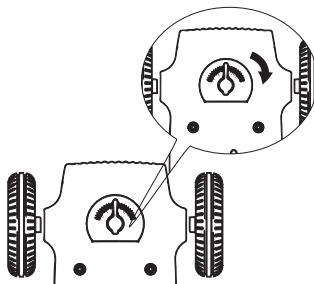
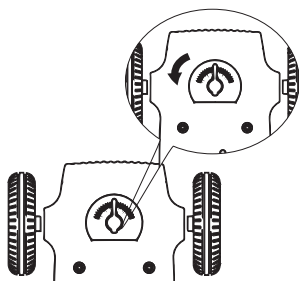

BLUETOOTH CONNECTION

1. Press and hold the switch button to turn on the car.
2. Open the phone settings, find out the hotspot named "QFX RC-1932" on the Bluetooth list and connected, (as shown on figure).
3. After the connection is successful, it is available to play music on the APP.

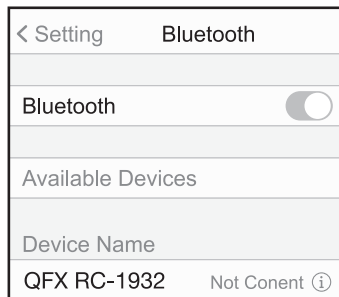

CHARGING DIRECTIONS

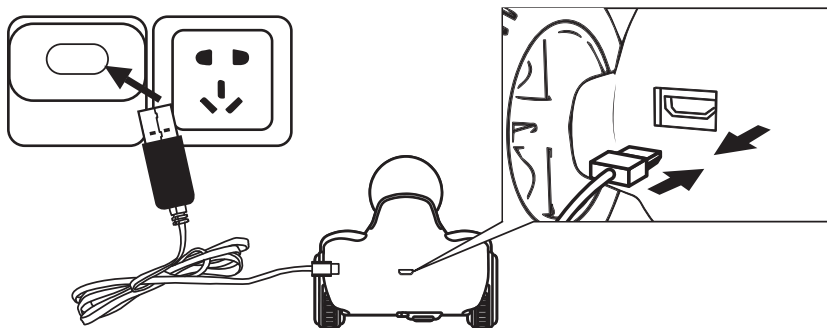

Plug the USB into the adapter and connect to the power. The USB indicator will always be on during the charging process, and be off after charging. The charging time is 90-120 minutes.

Note: Please use the 5V adapter and USB cable supplied with the product for charging

CONTROL REMOTO Y COCHE

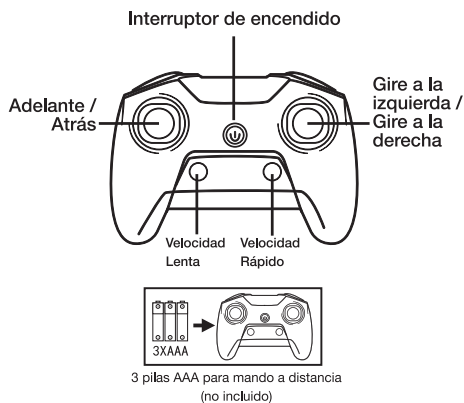

1. Mantenga presionado el interruptor de encendido para encender el control remoto, cuando la luz indicadora esté encendida, indique que los códigos están sincronizados, el automóvil está listo para usar.

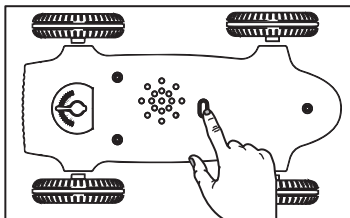
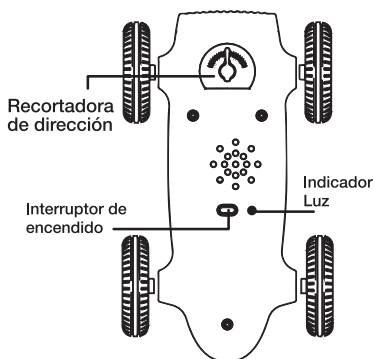

2. Mantenga presionado el interruptor de encendido durante aproximadamente un segundo para encender el automóvil. La luz indicadora parpadeará durante este tiempo, lo que indica que el automóvil se está emparejando con el control remoto.

RECORTADORA Y CALIBRACION

Si el vehículo se desvía hacia la izquierda, ajuste el botón del trimmer hacia la derecha hasta que avance en línea recta.

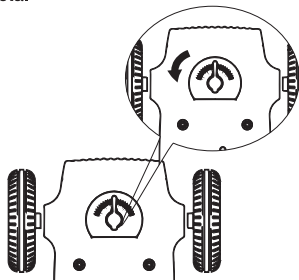

Si el vehículo se desvía hacia la derecha, ajuste el botón del trimmer hacia la izquierda hasta que conduzca en línea recta.

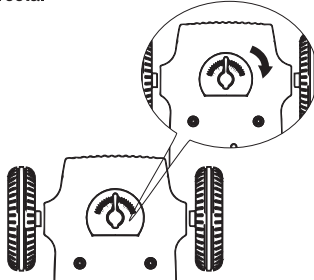

RECORTADORA Y CALIBRACION

1. Mantenga presionado el botón del interruptor para encender el automóvil.
2. Abra la configuración del teléfono, busque el punto de acceso llamado "QFX RC-1932" en la lista de Bluetooth y conéctelo (como se muestra en la figura).
3. Una vez que la conexión se haya realizado correctamente, podrá reproducir música en la aplicación.

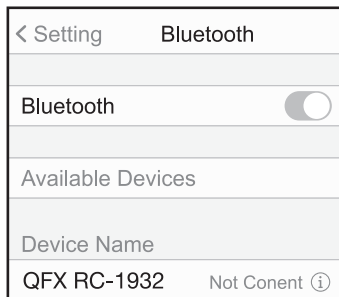
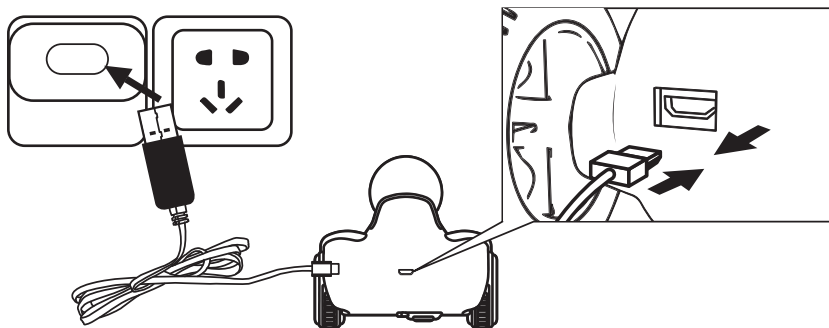
**INSTRUCCIONES DE CARGA**

Conecte el USB al adaptador y a la corriente. El indicador USB siempre estará encendido durante el proceso de carga y se apagará después de la carga. El tiempo de carga es de 90 a 120 minutos.

Nota: Utilice el adaptador de 5 V y el cable USB incluidos con el producto para cargarlo.

TÉLÉCOMMANDE ET VOITURE

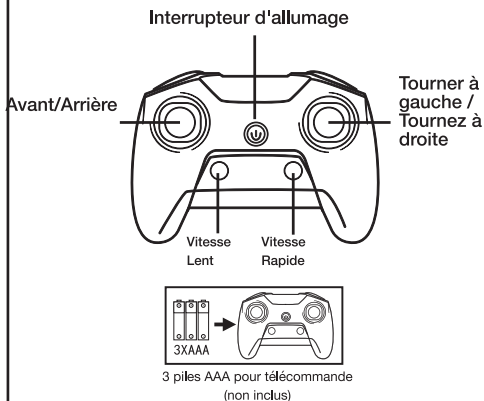

1. Appuyez longuement sur l'interrupteur d'alimentation pour allumer la télécommande, lorsque le voyant est allumé, indiquez que les codes sont synchronisés, la voiture est prête à être utilisée.

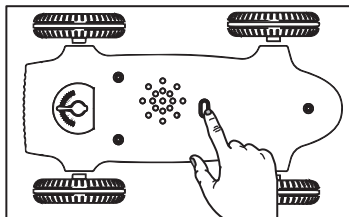
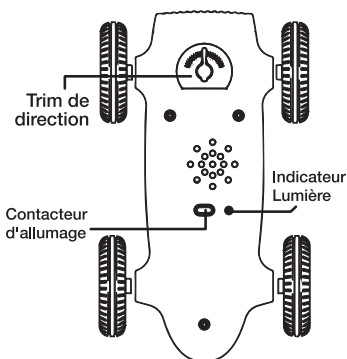

2. Appuyez et maintenez le contacteur d'allumage pendant environ une seconde pour démarrer la voiture. Le voyant clignote pendant ce temps, indiquant que la voiture est en cours de couplage avec la télécommande.

Tondeuse et calibrage

Si le véhicule tire vers la gauche, réglez le bouton du trim vers la droite jusqu'à ce qu'il se déplace tout droit.

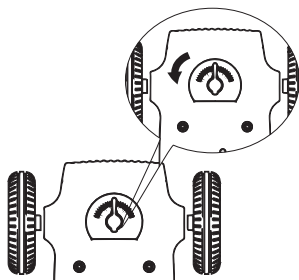

Si le véhicule tire vers la droite, réglez le bouton du trim vers la gauche jusqu'à ce qu'il roule tout droit.

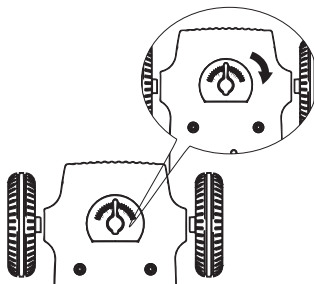

Tondeuse et calibrage

1. Appuyez et maintenez le bouton de commutation pour démarrer la voiture.
2. Ouvrez les paramètres du téléphone, recherchez le point d'accès nommé « QFX RC-1932 » dans la liste Bluetooth et connectez-le (comme indiqué sur la figure).
3. Une fois la connexion établie, vous pourrez écouter de la musique dans l'application.

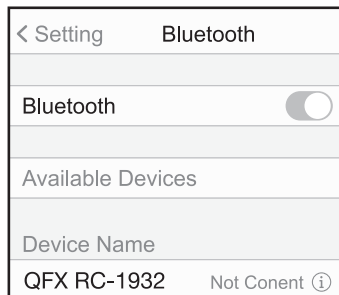
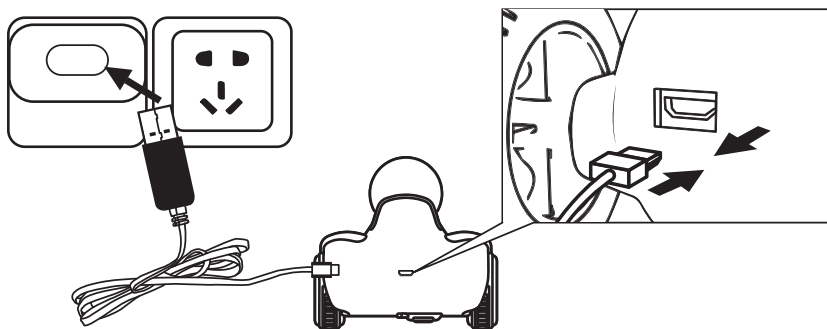
**INSTRUCTIONS DE CHARGE**

Connectez l'USB à l'adaptateur et à l'alimentation. L'indicateur USB sera toujours allumé pendant le processus de chargement et s'éteindra après le chargement. Le temps de charge est de 90 à 120 minutes.

Remarque : veuillez utiliser l'adaptateur 5 V et le câble USB inclus avec le produit pour le charger.



LIMITED PRODUCT WARRANTY POLICY

Before returning your Product for service under this Warranty, please (i) read the instruction manual carefully and visit our website at www.qfxusa.com for Product updates and extended support documentation (e.g., Common Troubleshooting Guides); (ii) if you are still having trouble with your Product, please contact the QFX Customer Support Department.

Subject to the terms and conditions herein, QFX, Inc. (herein after called "QFX") warrants to the original purchaser of the Product ("Customer") that for the applicable Warranty Period listed below, the Product will be free from defects in material or workmanship under normal, non-commercial use ("Defects").

Warranty Period encompasses, as listed below, separate "Coverage Periods" for Parts and Labor, each Coverage Period to begin from the original date of Customer purchase. If Customer returns a defective Product (or any component thereof) during the applicable Warranty Period, QFX will, at its option, during the specified Coverage Periods for Parts and Labor (as applicable either: (i) repair the Product (or, as applicable, any component thereof) or (ii) replace the Product (or, as applicable, any component thereof) with a new or refurbished Product (or, as applicable, any component thereof), in either case free of charge to Customer for Parts and/or Labor (as applicable) during the specified Coverage Period only, and excluding applicable shipping charges (noted below), for which the Customer is responsible. The foregoing states the Customer's exclusive remedy and QFX sole liability for breach of the limited warranty contained herein.

This warranty covers only normal use. This warranty is not transferable. QFX is not responsible for warranty replacement should the QFX label or logo be removed or should the product fail to be properly maintained or fail to function properly as a result of misuse, abuse, immersion in liquids, improper installation, improper shipping, damage caused by disasters such as fire, flood, or service other than by QFX. In addition, this warranty excludes any Product (or, as applicable, any component thereof) that has been subject to or Defects resulting from: (a) any neglect or misuse by a Customer, an accident, improper application, violation of operating instructions for the Product, any other Customer-induced damage, or the alteration or removal of any Product serial number; (b) any modification or repair to Product (or, as applicable, any component thereof) by any party other than QFX or a party authorized in writing by QFX; (c) any damage to Product (or, as applicable, any component thereof) due to power surges, incorrect electrical voltage, misconnection to any device, or malfunction of any device used with the Product (or, as applicable, any component thereof); (d) cosmetic damage to the Product (or, as applicable, any component thereof) caused by normal wear and tear; (e) shipping damage that occurs while the Product is in transit; (f) damage caused by heat sources, sunlight, electromagnetic conditions, or other climatic conditions or (g) any acts of God.

Product is sold to Customer for personal, non-commercial use only. Product is not warranted for Customer's commercial or rental use. In addition, Product is not warranted against failure, and should not be used by Customer for any application where (i) there is a risk that any data stored on Product will be breached or otherwise compromised, or (ii) the date stored on Product is relied upon for medical or lifesaving applications. QFX disclaims any Warranty for any of the foregoing uses to the fullest extent permitted by law. Customer assumes any and all risks associated with such uses of Product, and agrees to indemnify QFX for any damages claimed against QFX for such uses.

EXCEPT FOR EXPRESS WARRANTIES STATED ABOVE AND TO THE MAXIMUM EXTENT PERMITTED BY LAW, THE PRODUCTS ARE PROVIDED "AS IS" AND QFX DISCLAIMS ALL OTHER WARRANTIES, INCLUDING WITHOUT LIMITATION ANY IMPLIED WARRANTY (i) OF MERCHANTABILITY, (ii) OF FITNESS FOR A PARTICULAR PURPOSE, OR (iii) OF NON-INFRINGEMENT OF THIRD PARTY RIGHTS. TO THE MAXIMUM EXTENT PERMITTED BY APPLICABLE LAW, IN NO EVENT WILL QFX BE LIABLE TO CUSTOMER OR ANY THIRD PARTY FOR ANY INDIRECT, SPECIAL, INCIDENTAL, CONSEQUENTIAL, EXEMPLARY OR PUNITIVE DAMAGES, INCLUDING, WITHOUT LIMITATION, ANY LOST PROFITS OR REVENUES, LOSS OR INACCURACY OF ANY DATA OR COST OF SUBSTITUTE GOODS, REGARDLESS OF THE THEORY OF LIABILITY (INCLUDING NEGLIGENCE) AND EVEN IF QFX HAS BEEN ADVISED OF THE POSSIBILITY OF SUCH DAMAGES, QFX AGGREGATE LIABILITY TO CUSTOMER FOR ACTUAL DIRECT DAMAGES FOR ANY CAUSE WHATSOEVER SHALL BE LIMITED TO THE CUMULATIVE PRODUCT FEES PAID BY THAT CUSTOMER FOR THE PRODUCTS CAUSING THE DAMAGES, IF ANY.

This Warranty gives Customer specific rights, and Customer may also have other rights that vary from jurisdiction to jurisdiction. Warning: Some Products may contain components that are small enough to be swallowed. Please keep out of reach of children. In order for the return to be processed, you must send the Product PREPAID to the address below in the original packaging or reasonable substitute to prevent damage and include: (1) a dated sales receipt (which must have a purchase date that falls in the Warranty Period specified in the table below) that indicates the place of purchase, RC-1932 number of Product, and amount paid, (2) a detailed description of Customer's problem with Product, (3) Customer's full name, phone number, and return address, (3) all of the accessories that came with the Product package must be sent along with the main Product, (4) a cashier's check or money order payable to QFX, Inc., in the amount specified for the item in the product table below for return shipping and handling. If in the case you cannot provide a money order or cashier's check, you can contact The QFX Customer Support Representative to arrange payment via credit card. No returned Product will be shipped back to a PO BOX. If a returned Product is found to have no problem and/or does not include ALL of the requirements indicated above, it may be returned back to the customer and will not be processed.

QFX USA®, Inc.
RMA Processing
Customer Support Department
2957 E. 46th Street | Vernon, CA 90058

support@qfxusa.com
(800) 864-CLUB (2582) or (323) 864-6900
qfxusa.com
Hours of Operation: Monday - Friday, 9am - 5pm PST

All prices and details below are for US Destinations excluding, Hawaii, Alaska and Puerto Rico. For excluded destinations and NON US destinations, please contact The QFX Customer Support Department directly for additional shipping fees and return instructions.

If you do not find your Product below, your Product RC-1932 conflicts with multiple categories, and/or are unsure of which category the Product you have purchased will fall under, please contact our Customer Support Department for further instruction.

In order to determine the exact shipping cost that must be included with your proucut or paid for the product being returned, please refer to the table below. Please find the product you wish to return by category or RC-1932 number prefix. QFX will not provide any return or refund to any customer for merchandise and will only honor the Limited Warranty restrictions mentioned in this document.

Please make sure to follow all directions prior to shipping back your item. If you are not sure what the shipping cost for your item is, or if your item category conflicts in the table below, please feel free to contact the QFX Support Department for further assistance.

PRODUCT CATEGORY	HANDLING	LABOR	PARTS
Earphones, Headphones, Pocket Radios, & Small Bluetooth vSpeakers	\$5.00	1 Year	1 Year
Personal Stereos	\$10.00	1 Year	1 Year
Portable Radio/Cassette	\$15.00	1 Year	1 Year
Large Portable Radio Cassette	\$20.00	1 Year	1 Year
Mobile Audio	\$10.00	1 Year	1 Year
Pro Audio SBX Systems	\$75.00	1 Year	1 Year
Pro Audio PBX Systems	\$75.00	1 Year	1 Year
Televisions	\$25.00	1 Year	1 Year
Telephones	\$10.00	1 Year	1 Year

THE WARRANTY AND REMEDY PROVIDED ABOVE ARE EXCLUSIVE AND IN LIEU OF ALL OTHER EXPRESSED OR IMPLIED WARRANTIES INCLUDING, BUT NOT LIMITED TO, THE IMPLIED WARRANTIES OF MERCHANTABILITY, NON-INFRINGEMENT OR FITNESS FOR A PARTICULAR PURPOSE. SOME LAWS DO NOT ALLOW THE EXCLUSION OF IMPLIED WARRANTIES. IF THESE LAWS APPLY, THEN ALL EXPRESSED OR IMPLIED WARRANTIES ARE LIMITED TO THE WARRANTY PERIOD IDENTIFIED ABOVE. UNLESS STATED HEREIN, ANY STATEMENT OR REPRESENTATIONS MADE BY ANY OTHER PERSONS OR FIRM ARE VOID. EXCEPT AS PROVIDED IN THIS WRITTEN WARRANTY, QFX SHALL NOT BE LIABLE FOR ANY LOSS, INCONVENIENCE, OR DAMAGE, INCLUDING DIRECT, SPECIAL, INCIDENTAL OR CONSEQUENTIAL DAMAGES, RESULTING FROM THE USE OR INABILITY TO USE THE QFX PRODUCT, WHETHER RESULTING FROM BREACH OF WARRANTY OR ANY OTHER LEGAL THEORY.

Some jurisdictions do not allow limitations on how long an implied warranty lasts, and some jurisdictions do not allow the exclusion or limitation of incidental or consequential damages, so the above limitations and exclusions may not apply to you. This warranty gives you special legal rights and you may have other rights which vary from jurisdiction to jurisdiction.

Copyright Protected 2025 ©

1-800-864-2582
Mon-Fri 9AM - 5PM (PST)

support@qfxusa.com
Mon-Fri 9AM - 5PM (PST)



www.qfxusa.com

THANK YOU.

QFX Where the Party Begins!

We would love to hear about your RC-1932 Journey!
Tag us **@QFXUSA** to share your stories.

FOLLOW US @QFXUSA

