

QFX

WHERE THE PARTY BEGINS™



LMS-801SM

INSTRUCTION MANUAL

WARNING!

TO REDUCE THE RISK OF ELECTRIC SHOCK, DO NOT REMOVE THE COVER ON THIS SPEAKER. THERE ARE NO USER-SERVICEABLE PARTS INSIDE. REFER ALL SERVICING TO A QUALIFIED TECHNICIAN

To prevent fire or electric shock, do not expose this equipment to rain or moisture. Do not store or operate this product near any liquids, heat sources such as radiators, heat registers. Clean only with a dry cloth. Users should exhibit extra safety when this symbol appears in this instruction manual and follow all precautions as they are stated.

PARA REDUCIR EL RIESGO DE DESCARGA ELECTRICA, NO quite la cubierta en este altavoz. NO HAY PARTES REPARABLES POR EL USUARIO ADENTRO. SOLICITE EL SERVICIO A UN TECNICO CALIFICADO

Para evitar incendios o descargas electricas, no exponga este equipo a la lluvia o la humedad. No almacene o utilice este producto cerca de liquidos, fuentes de calor, como radiadores, acumuladores de calor. Limpie solo con un paño seco. Los usuarios deben exhibir una seguridad adicional cuando este simbolo aparece en este manual de instrucciones y siga todas las precauciones, ya que se han precisado.

LMS-801SM BATTERY

The LMS-801SM is a lithium battery powered PA loudspeaker.

Be sure that you have completely charged the battery prior to first use to maximize the battery's lifespan. Once the power adapter is connected to a power source, it will automatically begin charging (4-5 hours to fully charge the lithium battery) Even if the battery power is low, it will power on when connected to a power source. When the battery is charging, the battery indicator light is red. When the battery charge fully, the indicator light will turn off. Upon completion of the charging, Please disconnect the unit. When not in use, the speaker should always be set OFF to prevent the unit from draining the battery. When the unit is not used for prolonged periods of time, the battery will gradually lose its power. It is recommended to fully charge the battery at least every 60 days. When battery is completely empty, the unit cannot perform at 100% of the volume when immediately connected to power source. It is suggested to charge for a while before using with 100% volume. The unit may work and charge with lower level volume. The volume level would be increased as the unit is charging.

LMS-801SM BATERIA

El LMS-801SM es un altavoz PA alimentado por batería de litio.

Asegurese de haber cargado completamente la batería antes del primer uso para maximizar la batería vida útil. Una vez que el adaptador de corriente este conectado a una fuente de alimentación, comenzara a cargarse automaticamente. (4-5 horas para cargar completamente la batería de litio) Incluso si la carga de la batería es baja, se encendera cuando conectado a una fuente de alimentación. Cuando la batería se esta cargando, la luz indicadora de la batería es roja. Cuando la batería se cargue completamente, la luz indicadora se apagara. Al finalizar la carga, desconecte la unidad. Cuando no en uso, el altavoz siempre debe estar APAGADO para evitar que la unidad agote la batería. Cuando la unidad nose utiliza durante periodos prolongados de tiempo, la batería perdera gradualmente su potencia. Se recomienda Cargue completamente la batería al menos cada 60 días. Cuando la batería esta completamente vacia, la unidad no puede funcionar al 100% del volumen cuando se conecta inmediatamente a la fuente de alimentación. Se sugiere cargar por un tiempo antes de usar con un volumen del 100%, la unidad puede funcionar y cargar con un nivel de volumen mas bajo. El nivel de volumen aumentara a medida que la unidad se este cargando

LMS-801SM BLUETOOTH

Bluetooth Mode: Open the Bluetooth of phone. Find the Bluetooth name of the unit called "QFX LMS-801SM" to connect. After a successful match, you can play the music from speaker. You won't need reconnect the Bluetooth when switching mode.

LMS-801SM BLUETOOTH

Modo de Bluetooth: Abra el bluetooth de moilephone. Find el nombre del bluetooth de la unidad llamada "QFX LMS-801SM" para conectarse. Despues de una persona compatible, puede reproducir la musica de los altavoces. Usted no tendra que volver a conectar el Bluetooth cuando el modo de conmutación.

LMS-801SM REAR PANEL

1. Master volume Knob : Adjust from Min to Max
(Power Switch: ON/OFF)
2. Tone Knob: Adjust Treble&Bass
3. Microphone Volume Knob: Adjust from Min to Max
4. Mode Button: Toggle between AUX, USB, TF, FM, BT by short press, press and hold to turn light on or off
- Previous Track Button: Select previous track
- Play/Pause Button: (TWS connection)
- Next Track Button: Select next track by short press, press and hold to select/ exit Mic Priority
5. TF Card Slot
6. USB Slot
7. AUX IN
8. Microphone Input
9. Battery Indicator Light
10. Power Supply: DC 5V

LMS-801SM PANEL TRASERO

1. Perilla de volumen maestro: Ajuste de Min a Max
(Interruptor de encendido: ENCENDIDO/APAGADO)
2. Perilla de tono: ajuste de agudos y graves
3. Perilla de volumen del micrófono: Ajuste de Min a Max
4. Botón de modo: alternar entre AUX, USB, TF, FM, BT presionando brevemente, presione y mantenga presionado para encender o apagar la luz
- Botón de pista anterior: selecciona la pista anterior
- Botón de reproducción/pausa (conexión TWS)
- Botón Siguiente pista: seleccione la siguiente pista con una pulsación corta, manténgalo presionado para seleccionar/salir de Prioridad de micrófono
5. Ranura para tarjeta TF
6. Ranura USB
7. ENTRADA AUXILIAR
8. Entrada de micrófono
9. Luz indicadora de batería
10. Fuente de alimentación: CC 5VV

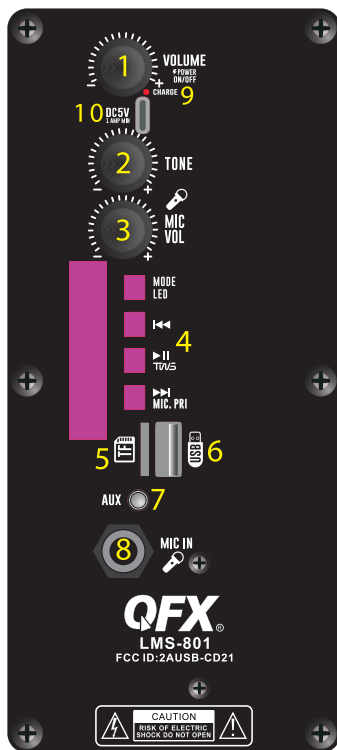

LMS-801SM DISPLAY SYSTEM SETTINGS

1. Input Mode: The LED display screen will display the information of input mode for USB/TF/BT AUX/FM. When a USB flash drive / TF Card is inserted into the USB/TF input, the unit will automatically switch to USB/TF mode and begin playing Mp3 audio files from the USB flash drive / TF Card.
2. Track Number: The track number currently playing from the USB/TF will display.
3. FM Mode: All FM channels display here. Short press "play/pause" button for auto scan all channels. When use FM mode, it suggest to turn off light to get a better FM effect.

LMS-801SM AJUSTES DEL SISTEMA DE PANTALLA

1. Modo de entrada: La pantalla LED mostrará la información del modo de entrada para USB / TF/BT AUX / FM. Cuando se inserta una unidad de tarjeta de memoria flash USB / TF en la entrada USB / TF, la unidad automáticamente cambiará al modo USB / TF y comenzará la reproducción de archivos de audio .mp3 del flash USB Card unidad / TF.
2. Track Número: El número que se está reproduciendo de la pista USB / TF se mostrará Modo
3. FM: Todos los canales de FM pantalla here. Court pulse el botón "reproducir / pausa" en el panel frontal para auto escanear todos los canales. Cuando use el modo FM, sugiera apagar la luz para obtener un mejor efecto FM.

LMS-801SM TWS CONNECTION

- (1) TWS connection: TWS Connection is only for two speakers, can not support quantity over 2 PCS.
- (2) Turn on the Speakers, press the MODE button to switch to BLUETOOTH mode, and the word "BLUE" on the LED screen will flash.
- (3) At the first time, please press the Play/Pause (TWS) button of one unit for 3 seconds. Then two speakers will connect together.
- (4) Connect the phone: Open the phone Bluetooth settings, Search and Connect the main device Bluetooth Name 'QFX LMS-801'.
- (5) Select music from phone and enjoy TWS playing in pairs with two Speakers.
- (6) Exit TWS: Long press the Play/Pause (TWS) button for 3 seconds to exit the TWS function

LMS-801SM CONEXION TWS

- (1) Conexión TWS: la conexión TWS es solo para dos altavoces, no puede admitir cantidades superiores a 2 PCS
- (2) Encienda los altavoces, presione el Botón de modo para cambiar al modo BLUETOOTH, y la palabra "BLUE" en la pantalla LED parpadeará.
- (3) La primera vez, presione el botón Reproducir / Pausa (TWS) de una unidad durante 3 segundos. Entonces dos altavoces se conectarán juntos.
- (4) Conecte el teléfono: abra la configuración Bluetooth del teléfono, busque y conecte el dispositivo principal Nombre de Bluetooth 'QFX LMS-801'.
- (5) Seleccione la música desde el teléfono y disfrute de TWS tocando en pareja con dos altavoces
- (6) Salir de TWS: mantenga presionado el Botón Reproducir / Pausa (TWS) durante 3 segundos para salir de la función TWS

LMS-801SM REMOTE CONTROL

1. STANDBY: Make the unit to be standby mode.
2. Input Mode Button: Toggle between USB, TF, FM, AUX, BT
3. Mute: Mute the track
4. PLAY/PAUSE
5. Previous Track: Select previous channel
6. Next Track: Select next channel.
7. EQ: Select EQ mode.
8. VOL-: Reduce the master volume
9. VOL+: Increase the master volume
10. REP: Repeat the playing track.
11. Press to Scan Channel in FM Mode
- 12-21. KEY Number for selecting the certain track for USB flash drive or TF card.

LMS-801SM REMOTE CONTROL

1. ESPERA: Hacer que la unidad sea el modo de espera.
2. Botón de modo de entrada: Cambia entre USB, TF, FM, AUX, BT
3. Silencio: silencia la pista
4. PLAY / PAUSA
5. Pista anterior: Seleccionar el canal permeable
6. Pista siguiente: Seleccionar el siguiente canal.
7. EQ: Seleccionar el modo EQ.
8. VOL -: Reducir el volumen maestro
9. VOL +: Incerase el volumen maestro
10. REP: Repetir la pista de juego.
11. Presión larga para explorar el canal en modo FM
- 12-21. KEY Número para seleccionar la pista determinada para la unidad flash USB o tarjeta de TF

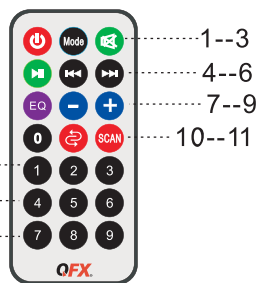

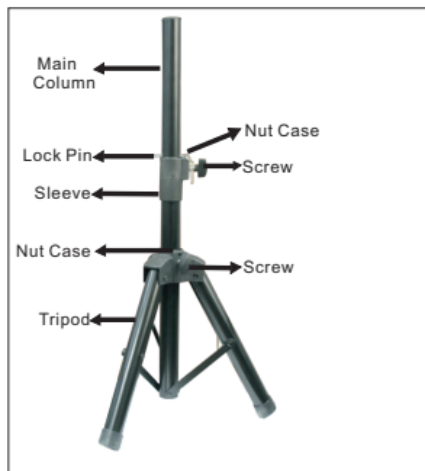
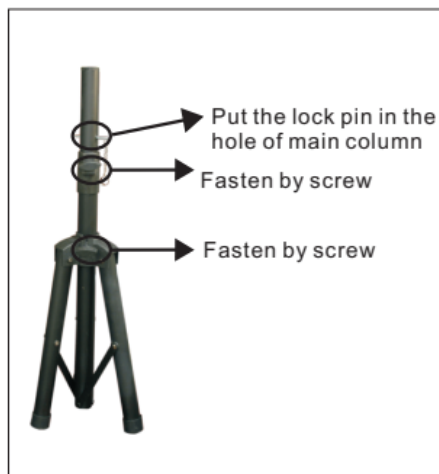
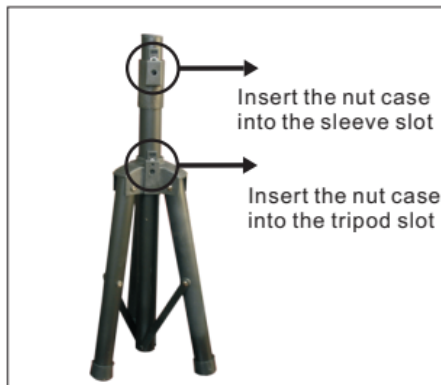
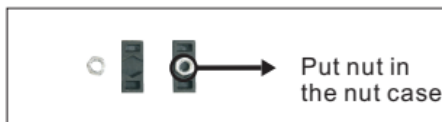
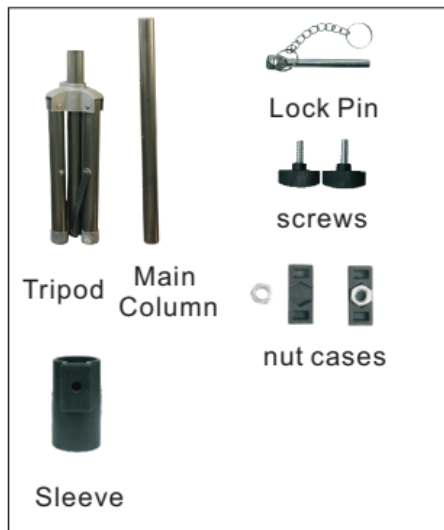

Instructions:

- 1: Take out the main column from the tripod and assemble them with the sleeve.
2. Put nuts inside the cases, insert one of the nut cases into the sleeve slot. Fasten with supplied screw.
3. Insert another nut cases into the tripod slot, and fasten with supplied screw
4. Insert the lock pin in the hole of main column to control the height.

Instrucciones:

- 1: Saque la columna principal del trípode y móntelas con la funda.
2. Coloque las tuercas dentro de las cajas, inserte una de las cajas de tuercas en la ranura del manguito. Sujete con el tornillo suministrado.
3. Inserte otras tuercas en la ranura del trípode y fíjelas con el tornillo suministrado
4. Inserte el pasador de bloqueo en el orificio de la columna principal para controlar la altura.



LIMITED PRODUCT WARRANTY POLICY

Before returning your Product for service under this Warranty, please (i) read the instruction manual carefully and visit our website at www.qfxusa.com for Product updates and extended support documentation (e.g., Common Troubleshooting Guides); (ii) if you are still having trouble with your Product, please contact the QFX Customer Support Department.

Subject to the terms and conditions herein, QFX, Inc. (herein after called "QFX") warrants to the original purchaser of the Product ("Customer") that for the applicable Warranty Period listed below, the Product will be free from defects in material or workmanship under normal, non-commercial use ("Defects").

Warranty Period encompasses, as listed below, separate "Coverage Periods" for Parts and Labor, each Coverage Period to begin from the original date of Customer purchase. If Customer returns a defective Product (or any component thereof) during the applicable Warranty Period, QFX will, at its option, during the specified Coverage Periods for Parts and Labor (as applicable either: (i) repair the Product (or, as applicable, any component thereof) or (ii) replace the Product (or, as applicable, any component thereof) with a new or refurbished Product (or, as applicable, any component thereof), in either case free of charge to Customer for Parts and/or Labor (as applicable) during the specified Coverage Period only, and excluding applicable shipping charges (noted below), for which the Customer is responsible. The foregoing states the Customer's exclusive remedy and QFX sole liability for breach of the limited warranty contained herein.

This warranty covers only normal use. This warranty is not transferable. QFX is not responsible for warranty replacement should the QFX label or logo be removed or should the product fail to be properly maintained or fail to function properly as a result of misuse, abuse, immersion in liquids, improper installation, improper shipping, damage caused by disasters such as fire, flood, or service other than by QFX. In addition, this warranty excludes any Product (or, as applicable, any component thereof) that has been subject to or Defects resulting from: (a) any neglect or misuse by a Customer, an accident, improper application, violation of operating instructions for the Product, any other Customer-induced damage, or the alteration or removal of any Product serial number; (b) any modification or repair to Product (or, as applicable, any component thereof) by any party other than QFX or a party authorized in writing by QFX; (c) any damage to Product (or, as applicable, any component thereof) due to power surges, incorrect electrical voltage, misconnection to any device, or malfunction of any device used with the Product (or, as applicable, any component thereof); (d) cosmetic damage to the Product (or, as applicable, any component thereof) caused by normal wear and tear; (e) shipping damage that occurs while the Product is in transit; (f) damage caused by heat sources, sunlight, electromagnetic conditions, or other climatic conditions or (g) any acts of God.

Product is sold to Customer for personal, non-commercial use only. Product is not warranted for Customer's commercial or rental use. In addition, Product is not warranted against failure, and should not be used by Customer for any application where (i) there is a risk that any data stored on Product will be breached or otherwise compromised, or (ii) the data stored on Product is relied upon for medical or lifesaving applications. QFX disclaims any Warranty for any of the foregoing uses to the fullest extent permitted by law. Customer assumes any and all risks associated with such uses of Product, and agrees to indemnify QFX for any damages claimed against QFX for such uses.

EXCEPT FOR EXPRESS WARRANTIES STATED ABOVE AND TO THE MAXIMUM EXTENT PERMITTED BY LAW, THE PRODUCTS ARE PROVIDED "AS IS" AND QFX DISCLAIMS ALL OTHER WARRANTIES, INCLUDING WITHOUT LIMITATION ANY IMPLIED WARRANTY (i) OF MERCHANTABILITY, (ii) OF FITNESS FOR A PARTICULAR PURPOSE, OR (iii) OF NON-INFRINGEMENT OF THIRD PARTY RIGHTS. TO THE MAXIMUM EXTENT PERMITTED BY APPLICABLE LAW, IN NO EVENT WILL QFX BE LIABLE TO CUSTOMER OR ANY THIRD PARTY FOR ANY INDIRECT, SPECIAL, INCIDENTAL, CONSEQUENTIAL, EXEMPLARY OR PUNITIVE DAMAGES, INCLUDING, WITHOUT LIMITATION, ANY LOST PROFITS OR REVENUES, LOSS OR INACCURACY OF ANY DATA OR COST OF SUBSTITUTE GOODS, REGARDLESS OF THE THEORY OF LIABILITY (INCLUDING NEGLIGENCE) AND EVEN IF QFX HAS BEEN ADVISED OF THE POSSIBILITY OF SUCH DAMAGES, QFX AGGREGATE LIABILITY TO CUSTOMER FOR ACTUAL DIRECT DAMAGES FOR ANY CAUSE WHATSOEVER SHALL BE LIMITED TO THE CUMULATIVE PRODUCT FEES PAID BY THAT CUSTOMER FOR THE PRODUCTS CAUSING THE DAMAGES, IF ANY.

This Warranty gives Customer specific rights, and Customer may also have other rights that vary from jurisdiction to jurisdiction. Warning: Some Products may contain components that are small enough to be swallowed. Please keep out of reach of children. In order for the return to be processed, you must send the Product PREPAID to the address below in the original packaging or reasonable substitute to prevent damage and include: (1) a dated sales receipt (which must have a purchase date that falls in the Warranty Period specified in the table below) that indicates the place of purchase, model number of Product, and amount paid, (2) a detailed description of Customer's problem with Product, (3) Customer's full name, phone number, and return address, (3) all of the accessories that came with the Product package must be sent along with the main Product, (4) a cashier's check or money order payable to QFX, Inc., in the amount specified for the item in the product table below for return shipping and handling. If in the case you cannot provide a money order or cashier's check, you can contact The QFX Customer Support Representative to arrange payment via credit card. No returned Product will be shipped back to a PO BOX. If a returned Product is found to have no problem and/or does not include ALL of the requirements indicated above, it may be returned back to the customer and will not be processed.

QFX USA®, Inc.
RMA Processing
Customer Support Department
2957 E. 46th Street | Vernon, CA 90058

support@qfxusa.com
(800) 864-CLUB (2582) or (323) 864-6900
qfxusa.com
Hours of Operation: Monday - Friday, 9am - 5pm PST

All prices and details below are for US Destinations excluding, Hawaii, Alaska and Puerto Rico. For excluded destinations and NON US destinations, please contact The QFX Customer Support Department directly for additional shipping fees and return instructions.

If you do not find your Product below, your Product model conflicts with multiple categories, and/or are unsure of which category the Product you have purchased will fall under, please contact our Customer Support Department for further instruction.

In order to determine the exact shipping cost that must be included with your product or paid for the product being returned, please refer to the table below. Please find the product you wish to return by category or model number prefix. QFX will not provide any return or refund to any customer for merchandise and will only honor the Limited Warranty restrictions mentioned in this document.

Please make sure to follow all directions prior to shipping back your item. If you are not sure what the shipping cost for your item is, or if your item category conflicts in the table below, please feel free to contact the QFX Support Department for further assistance.

PRODUCT CATEGORY	HANDLING	LABOR	PARTS
Earphones, Headphones, Pocket Radios, & Small Bluetooth vSpeakers	\$5.00	1 Year	1 Year
Personal Stereos	\$10.00	1 Year	1 Year
Portable Radio/Cassette	\$15.00	1 Year	1 Year
Large Portable Radio Cassette	\$20.00	1 Year	1 Year
Mobile Audio	\$10.00	1 Year	1 Year
Pro Audio SBX Systems	\$75.00	1 Year	1 Year
Pro Audio PBX Systems	\$75.00	1 Year	1 Year
Televisions	\$25.00	1 Year	1 Year
Telephones	\$10.00	1 Year	1 Year

THE WARRANTY AND REMEDY PROVIDED ABOVE ARE EXCLUSIVE AND IN LIEU OF ALL OTHER EXPRESSED OR IMPLIED WARRANTIES INCLUDING, BUT NOT LIMITED TO, THE IMPLIED WARRANTIES OF MERCHANTABILITY, NON-INFRINGEMENT OR FITNESS FOR A PARTICULAR PURPOSE. SOME LAWS DO NOT ALLOW THE EXCLUSION OF IMPLIED WARRANTIES. IF THESE LAWS APPLY, THEN ALL EXPRESSED OR IMPLIED WARRANTIES ARE LIMITED TO THE WARRANTY PERIOD IDENTIFIED ABOVE. UNLESS STATED HEREIN, ANY STATEMENT OR REPRESENTATIONS MADE BY ANY OTHER PERSONS OR FIRM ARE VOID. EXCEPT AS PROVIDED IN THIS WRITTEN WARRANTY, QFX SHALL NOT BE LIABLE FOR ANY LOSS, INCONVENIENCE, OR DAMAGE, INCLUDING DIRECT, SPECIAL, INCIDENTAL OR CONSEQUENTIAL DAMAGES, RESULTING FROM THE USE OR INABILITY TO USE THE QFX PRODUCT, WHETHER RESULTING FROM BREACH OF WARRANTY OR ANY OTHER LEGAL THEORY.

Some jurisdictions do not allow limitations on how long an implied warranty lasts, and some jurisdictions do not allow the exclusion or limitation of incidental or consequential damages, so the above limitations and exclusions may not apply to you. This warranty gives you special legal rights and you may have other rights which vary from jurisdiction to jurisdiction.

Copyright Protected 2023 ©



1-800-864-CLUB (2582)
Mon-Fri 9AM - 5PM (PST)



support@qfxusa.com
Mon-Fri 9AM - 5PM (PST)



www.qfxusa.com

THANK YOU.

Enjoy your speaker and make many memories with it because
QFX is Where the Party Begins!

We would love to hear about your LMS-801SM Journey!
Tag us **@QFXUSA** to share your stories.

