

FX-203

QFX
WHERE THE PARTY BEGINS™



 **Bluetooth™**

INSTRUCTION MANUAL

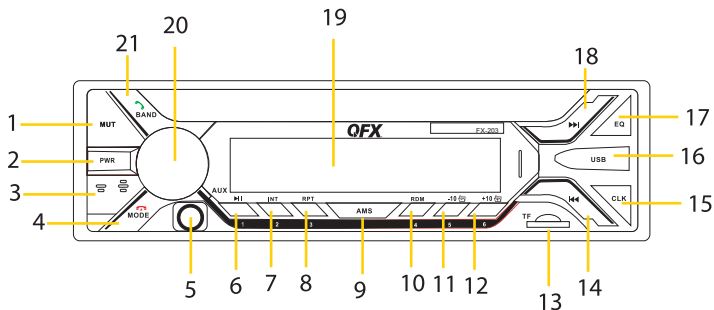

1. ANTENNA
2. RCA OUTPUT: L (White) R (Red)
3. ISO - A CONNECTOR
4. ISO - B CONNECTOR

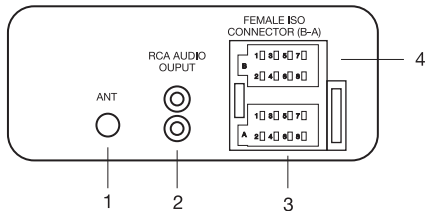

ISO CONNECTOR A

1. -----
2. -----
3. -----
4. POWER SUPPLY (+12V YELLOW)
5. AUTO ANTENNA (BLUE)
6. -----
7. ACC+ (+12V ACCESSORY RED)
8. GROUND (BLACK)

ISO CONNECTOR B

1. RR+ (REAR RIGHT+ PURPLE)
2. RR- (REAR RIGHT- PURPLE/BLACK)
3. FR+ (FRONT RIGHT + GREY)
4. FR- (FRONT RIGHT - GREY/BLACK)
5. FL+ (FRONT LEFT + WHITE)
6. FL- (FRONT LEFT - WHITE/BLACK)
7. RL+ (REAR LEFT + GREEN)
8. RL- (REAR LEFT - GREEN/BLACK)



FX-203 FUNCTIONS

1. Mute: Audio
2. Power ON/OFF
3. Microphone: Talk back Microphone for phone call
4. Mode: Press to select a Mode: Tuner/BT AUX/USB/TF. Press to End Call.
5. Aux: Connect an external; audio device using a 3.5mm TRS cable.
6. Play/Pause: (Program radio station 1)
7. Int: Press to play the first 10 seconds of a file. press again to exit (Program radio station 2).
8. Repeat: Track in USB/TF Mode (Program3)
9. AMS: Enter the Audio Menu Settings to adjust EQ, Balance, and Fade using the volume wheel.
10. RDM: Shuffle tracks in USB/TF Mode. (Program radio station 4)
11. 10 Track Rewind: Move 10 tracks at a time. (Program radio station 5)
12. 10 Track Forward : Move 10 tracks at a time (Program radio station 6)
13. TF/Card Port: Insert aTF Card for music playback
14. Previous: Radio station or USB/TF track.
15. Clock: Press to display time. Press and hold to set clock. Use the volume knob to set the time.
16. USB Port: Connect a mobile device or USB for music playback.
18. Next: Radio station or USB/TF track.
17. Equalizer Settings: Select Rock, Vocal, Jazz, Flat, Classical, Electronic, Pop, EQ OFF.
19. Display: Displays the unit's function.
20. Volume Knob: Turn to increase and decrease the volume. Press multiple times for sub settings.
21. Band/Answer Call.
1. Silencio: Audio
2. Encendido / apagado
3. Micrófono: Micrófono de respuesta para llamadas telefónicas
4. Modo: presione para seleccionar un modo: Sintonizador / BT AUX / USB / TF. Presione para finalizar la llamada.
5. Aux: conecta un externo; dispositivo de audio utilizando un cable TRS de 3,5 mm.
6. Reproducir / Pausar: (Programa la estación de radio 1)
7. Int: presione para explorar los archivos USB / TF y carpetas. (Programar la emisora de radio 2).
8. Repetir: Pista en modo USB / TF (Programa3)
9. AMS: Ingrese a la configuración del menú de audio para ajustar EQ, Balance y Fade usando la rueda de volumen.
10. Aleatorio: reproducción aleatoria de pistas en modo USB / TF. (Programar la emisora de radio 4)
11. Rebobinado de 10 pistas: mueva 10 pistas a la tiempo. (Programar la emisora de radio 5)
12. 10 pistas hacia adelante: mueve 10 pistas a la tiempo (programa la emisora de radio 6)
13. Puerto TF / Card: inserte una tarjeta TF para reproducir música
14. Anterior: estación de radio o pista USB / TF.
15. Reloj: presione para mostrar la hora. Presione y mantén pulsado para configurar el reloj. Usa la perilla de volumen para configurar la hora.
16. Puerto USB: conecte un dispositivo móvil o USB para reproducción de música.
18. Siguiente: estación de radio o pista USB / TF.
17. Configuración del ecualizador: seleccione Rock, Vocal, Jazz, Flat, Classical, Electronic, Pop, EQ OFF.
19. Pantalla: muestra la función de la unidad.
20. Perilla de volumen: gírela para aumentar y bajar el volumen. Presione múltiples tiempos para subconfiguraciones.
21. Llamada de banda / respuesta.
1. Muet : Audio
2. Mise sous/hors tension
3. Microphone: Talk back Microphone pour appel téléphonique
4. Mode : Appuyez pour sélectionner un Mode : Tuner/BT AUX/USB/TF. Appuyez sur pour terminer l'appel.
5. Aux : connectez un externe ; appareil audio à l'aide d'un câble TRS de 3,5 mm.
6. Lecture/Pause : (Programmer la station de radio 1)
7. Int : Appuyez pour parcourir les fichiers USB/TF et Dossiers. (Programmer la station de radio 2).
8. Répéter : piste en mode USB/TF (Program3)
9. AMS : accédez aux paramètres du menu audio pour régler l'égaliseur, la balance et le fondu à l'aide de la molette de volume.
10. Aléatoire : lecture aléatoire des pistes en mode USB/TF. (Programme radio 4)
11. Rembobinage de 10 pistes : Déplacez 10 pistes à la temps. (Programme radio 5)
12. 10 pistes en avant : Déplacez 10 pistes à la fois heure (programmer la station de radio 6)
13. Port TF/Card : insérez une carte TF pour la lecture de musique
14. Précédent : Station de radio ou piste USB/TF.
15. Horloge : Appuyez pour afficher l'heure. Appuyez sur et maintenez pour régler l'horloge. Utilisez le bouton de volume pour régler l'heure.
16. Port USB : Connectez un appareil mobile ou USB pour la lecture de musique.
18. Suivant : Station de radio ou piste USB/TF.
17. Paramètres de l'égaliseur : sélectionnez Rock, Vocal, Jazz, Flat, Classical, Electronic, Pop, EQ OFF.
19. Affichage : Affiche la fonction de l'unité.
20. Bouton de volume : Tournez pour augmenter et diminuer le volume. Appuyez sur plusieurs fois pour les sous-paramètres.
21. Bande/Répondre à l'appel.



FX-203 GUIDE

CLOCK: Press and hold "CLK" to enter clock settings. Use the volume knob to set the HOUR. Press the volume knob to set the MINUTE. Once the hour and minutes are set, Press and Hold the "CLK" button to lock in the time.

VOLUME KNOB: Turn to adjust the volume. Press the knob to select sub functions: BASS: Adjust the bass volume, TREBLE: Adjust the treble volume.

BALANCE: Adjust the sound image to the Left, Center, or Right side of the vehicle. **FADE:** Adjust the sound image to the Front, Center, or back side of the vehicle. **LOUD:** Select ON/OFF to diminish the volume. **EQ:** Select an EQ preset. Press and hold for 3 seconds to activate Siri.

NEXT/PREVIOUS: Press and hold in FM/AM mode for manual search.

PROGRAM: In AM/FM mode select a radio station and press and hold the AMS button (1-6) to store the radio station. Select the program number and press to store the channel.

BLUETOOTH: Use the MODE button to select "BT". On your mobile device enable Bluetooth and search for QFX FX-203. Select QFX FX-203 to pair with the unit. Select your favorite music app to play back your music. To receive a Phone call Press the "BAND" button. To end a call press the "MODE" button. If a password is required use "0000".

RELOJ: Mantenga presionado "CLK" para ingresar a la configuración del reloj. Use la perilla de volumen para configurar la HORA. Presione la perilla de volumen para configurar los MINUTOS. Una vez configurados la hora y los minutos, presione y mantenga presionado el botón "CLK" para fijar la hora.

PERILLA DE VOLUMEN: Girela para ajustar el volumen. Presione la perilla para seleccionar las subfunciones: BASS: Ajusta el volumen de los graves. TREBLE: ajusta el volumen de los agudos. BALANCE: ajusta la imagen de sonido al lado izquierdo, central o derecho del vehículo. FADE: ajusta la imagen de la sonda a la parte delantera, central o trasera del vehículo. LOUD: Seleccione ON / OFF para disminuir el volumen. EQ: selecciona un preajuste de EQ. Mantenga pulsado durante 3 segundos para activar Siri.

SIGUIENTE / ANTERIOR: Mantenga presionado en el modo FM / AM para la búsqueda manual.

PROGRAMA: En el modo AM / FM, seleccione una estación de radio y mantenga presionado el botón AMS (1-6) para almacenar la estación de radio. Seleccione el número de programa y presione para almacenar el canal.

BLUETOOTH: Use el botón MODE para seleccionar "BT". En su dispositivo móvil, habilite Bluetooth y busque QFX FX-203. Seleccione QFX FX-203 para emparejar con la unidad. Seleccione su aplicación de música favorita para reproducir su música. Para recibir una llamada telefónica Presione el botón "BAND". Para finalizar una llamada, presione el botón "MODE". Si se requiere una contraseña, use "0000".

HORLOGE : Appuyez et maintenez enfoncée la touche « CLK » pour entrer les paramètres de l'horloge. Utilisez le bouton de volume pour régler l'HEURE.

Appuyez sur le bouton de volume pour régler les MINUTES. Une fois l'heure et les minutes réglées, maintenez enfoncé le bouton « CLK » pour verrouiller l'heure.

BOUON DE VOLUME : Tournez pour régler le volume. Appuyez sur le bouton pour sélectionner les sous-fonctions : BASS : Réglez le volume des basses.

TREBLE : Ajustez le volume des aigus. **BALANCE :** Ajustez l'image sonore sur le côté gauche, central ou droit du véhicule. **FONDU :** Ajustez l'image sonore à l'avant, au centre ou à l'arrière du véhicule. **LOUD :** Sélectionnez ON/OFF pour diminuer le volume. **EQ :** sélectionnez un pré réglage d'égaliseur. Appuyez et maintenez enfoncé pendant 3 secondes pour activer Siri.

SUIVANT/PRÉCÉDENT : Appuyez et maintenez en mode FM/AM pour une recherche manuelle.

PROGRAMME : En mode AM/FM, sélectionnez une station de radio et maintenez enfoncé le bouton AMS (1-6) pour mémoriser la station de radio. Sélectionnez le numéro de programme et appuyez sur pour mémoriser la chaîne.

BLUETOOTH : Utilisez le bouton MODE pour sélectionner « BT ». Sur votre appareil mobile, activez Bluetooth et recherchez QFX FX-203. Sélectionnez QFX FX-203 à coupler avec l'unité. Sélectionnez votre application musicale préférée pour lire votre musique. Pour recevoir un appel téléphonique Appuyez sur le bouton « BAND ». Pour terminer un appel, appuyez sur le bouton « MODE ». Si un mot de passe est requis, utilisez « 0000 ».

INSTALLATION

1. This player should be installed by professional technician.
2. please read the instruction and operation of equipment carefully before installing.
3. Make sure to connect other wires before power connection.
4. To avoid short circuit. Please make sure all the exposed wire are insulating.
5. please fix all the wires after installation.
6. please make connection to the player accordingly to this instruction manual. Wrong connection may cause damage.
7. This player only fit for 12V DC device and please make sure your car belongs to this kind of cathode grounding electrical system.
8. Please connect the wires rightly. Wrong connection will cause malfunction or damage the electrical system.

1. Este reproductor debe ser instalado por un técnico profesional.
2. Lea atentamente las instrucciones y el funcionamiento del equipo antes de instalarlo.
3. Asegúrese de conectar otros cables antes de conectar la alimentación.
4. Para evitar cortocircuitos. Asegúrese de que todos los cables expuestos sean aislantes.
5. Repare todos los cables después de la instalación.
6. Realice la conexión con el reproductor de acuerdo con este manual de instrucciones. Una conexión incorrecta puede causar daños.
7. Este reproductor solo es apto para dispositivos de 12 V CC y asegúrese de que su automóvil pertenezca a este tipo de sistema eléctrico de conexión a tierra de cátodo.
8. Conecte los cables correctamente. Una conexión incorrecta provocará un mal funcionamiento o dañará el sistema eléctrico.

1. Ce lecteur doit être installé par un technicien professionnel.
2. veuillez lire attentivement les instructions et le fonctionnement de l'équipement avant l'installation.
3. Assurez-vous de connecter d'autres fils avant la connexion électrique.
4. Pour éviter les courts-circuits. Veuillez vous assurer que tous les fils exposés sont isolants.
5. veuillez réparer tous les fils après l'installation.
6. veuillez effectuer la connexion au lecteur conformément à ce manuel d'instructions. Une mauvaise connexion peut causer des dommages.
7. Ce lecteur ne convient qu'aux appareils 12V DC et assurez-vous que votre voiture appartient à ce type de système électrique de mise à la terre de la cathode.
8. Veuillez connecter les fils correctement. Une mauvaise connexion entraînera un dysfonctionnement ou endommagera le système électrique.

INSTALL THE UNIT

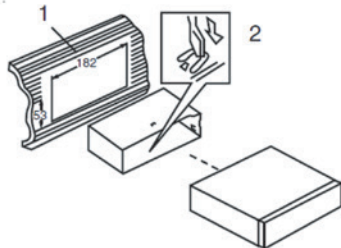

USE THE PROVIDED PINS TO REMOVE THE CURRENT UNIT.
INSERT THE PINS ON BOTH SIDES AN PULL THE UNIT OUT



Power Supply: DC 12 Volts, Negative Ground
Chassis Dimensions: 185 (W) x 85 (D) x 50 (H)
Maximum Output Power: 4x30 watts
Current Drain: 10 Ampere (max.)
Radio: FM 87.5 - 108 MHz/ AM 522- 1620 kHz
Sensitivity: (S/N =20dB) 36 dBuV



FOLLOW US @QFXUSA





LIMITED PRODUCT WARRANTY POLICY

Before returning your Product for service under this Warranty, please (i) read the instruction manual carefully and visit our website at www.qfxusa.com for Product updates and extended support documentation (e.g., Common Troubleshooting Guides); (ii) if you are still having trouble with your Product, please contact the QFX Customer Support Department.

Subject to the terms and conditions herein, QFX, Inc. (herein after called "QFX") warrants to the original purchaser of the Product ("Customer") that for the applicable Warranty Period listed below, the Product will be free from defects in material or workmanship under normal, non-commercial use ("Defects").

Warranty/Period encompasses, as listed below, separate "Coverage Periods" for Parts and Labor, each Coverage Period to begin from the original date of Customer purchase. If Customer returns a defective Product (or any component thereof) during the applicable Warranty Period, QFX will, at its option, during the specified Coverage Periods for Parts and Labor (as applicable either: (i) repair the Product (or, as applicable, any component thereof) or (ii) replace the Product (or, as applicable, any component thereof) with a new or refurbished Product (or, as applicable, any component thereof), in either case free of charge to Customer for Parts and/or Labor (as applicable) during the specified Coverage Period only, and excluding applicable shipping charges (noted below), for which the Customer is responsible. The foregoing states the Customer's exclusive remedy and QFX sole liability for breach of the limited warranty contained herein.

This warranty covers only normal use. This warranty is not transferable. QFX is not responsible for warranty replacement should the QFX label or logo be removed or should the product fail to be properly maintained or fail to function properly as a result of **misuse, abuse, immersion in liquids, improper installation, improper shipping, damage caused by disasters such as fire, flood, or service other than by QFX**. In addition, this warranty excludes any Product (or, as applicable, any component thereof) that has been subject to or Defects resulting from: (a) any neglect or misuse by a Customer, an accident, improper application, violation of operating instructions for the Product, any other Customer-induced damage, or the alteration or removal of any Product serial number; (b) any modification or repair to Product (or, as applicable, any component thereof) by any party other than QFX or a party authorized in writing by QFX; (c) any damage to Product (or, as applicable, any component thereof) due to power surges, incorrect electrical voltage, misconnection to any device, or malfunction of any device used with the Product (or, as applicable, any component thereof); (d) cosmetic damage to the Product (or, as applicable, any component thereof) caused by normal wear and tear; (e) shipping damage that occurs while the Product is in transit; (f) damage caused by heat sources, sunlight, electromagnetic conditions, or other climatic conditions or (g) any acts of God.

Product is sold to Customer for personal, non-commercial use only. Product is not warranted for Customer's commercial or rental use. In addition, Product is not warranted against failure, and should not be used by Customer for any application where (i) there is a risk that any data stored on Product will be breached or otherwise compromised, or (ii) the data stored on Product is relied upon for medical or lifesaving applications. QFX disclaims any Warranty for any of the foregoing uses to the fullest extent permitted by law. Customer assumes any and all risks associated with such uses of Product, and agrees to indemnify QFX for any damages claimed against QFX for such uses.

EXCEPT FOR EXPRESS WARRANTIES STATED ABOVE AND TO THE MAXIMUM EXTENT PERMITTED BY LAW, THE PRODUCTS ARE PROVIDED "AS IS" AND QFX DISCLAIMS ALL OTHER WARRANTIES, INCLUDING WITHOUT LIMITATION ANY IMPLIED WARRANTY (I) OF MERCHANTABILITY, (II) OF FITNESS FOR A PARTICULAR PURPOSE, OR (III) OF NON-INFRINGEMENT OF THIRD PARTY RIGHTS, TO THE MAXIMUM EXTENT PERMITTED BY APPLICABLE LAW, IN NO EVENT WILL QFX BE LIABLE TO CUSTOMER OR ANY THIRD PARTY FOR ANY INDIRECT, SPECIAL, INCIDENTAL, CONSEQUENTIAL, EXEMPLARY OR PUNITIVE DAMAGES, INCLUDING, WITHOUT LIMITATION, ANY LOST PROFITS OR REVENUES, LOSS OR INACCURACY OF ANY DATA OR COST OF SUBSTITUTE GOODS, REGARDLESS OF THE THEORY OF LIABILITY (INCLUDING NEGLIGENCE) AND EVEN IF QFX HAS BEEN ADVISED OF THE POSSIBILITY OF SUCH DAMAGES. QFX AGGREGATE LIABILITY TO CUSTOMER FOR ACTUAL DIRECT DAMAGES FOR ANY CAUSE WHATSOEVER SHALL BE LIMITED TO THE CUMULATIVE PRODUCT FEES PAID BY THAT CUSTOMER FOR THE PRODUCTS CAUSING THE DAMAGES, IF ANY.

This Warranty gives Customer specific rights, and Customer may also have other rights that vary from jurisdiction to jurisdiction. Warning: Some Products may contain components that are small enough to be swallowed. Please keep out of reach of children. In order for the return to be processed, you must send the Product (PREPAID) to the address below in the original packaging or reasonable substitute to prevent damage and include: (1) a dated sales receipt (which must have a purchase date that falls in the Warranty Period specified in the table below) that indicates the place of purchase, model number of Product, and amount paid, (2) a detailed description of Customer's problem with Product, (3) Customer's full name, phone number, and return address, (3) all of the accessories that came with the Product package must be sent along with the main Product, (4) a cashier's check or money order payable to QFX, Inc., in the amount specified for the item in the product table below for return shipping and handling. If in the case, you cannot provide a money order or cashier's check, you can contact The QFX Customer Support Representative to arrange payment via credit card. No returned Product will be shipped back to a PO BOX. If a returned Product is found to have no problem and/or does not include ALL of the requirements indicated above, it may be returned back to the customer and will not be processed.

QFX USA®, Inc.
RMA Processing
Customer Support Department
2957 E. 46th Street | Vernon, CA 90058

support@qfxusa.com
(800) 864-CLUB (2582) or (323) 864-6900
qfxusa.com
Hours of Operation: Monday - Friday, 9am - 5pm PST

All prices and details below are for US Destinations excluding: Hawaii, Alaska and Puerto Rico. For excluded destinations and NON US destinations, please contact The QFX Customer Support Department directly for additional shipping fees and return instructions.

If you do not find your Product below, your Product model conflicts with multiple categories, and/or are unsure of which category the Product you have purchased will fall under, please contact our Customer Support Department for further instruction.

In order to determine the exact shipping cost that must be included with your product or paid for the product being returned, please refer to the table below. Please find the product you wish to return by category or model number prefix. QFX will not provide any return or refund to any customer for merchandise and will only honor the Limited Warranty restrictions mentioned in this document.

Please make sure to follow all directions prior to shipping back your item. If you are not sure what the shipping cost for your item is, or if your item category conflicts in the table below, please feel free to contact the QFX Support Department for further assistance.

PRODUCT CATEGORY	HANDLING	LABOR	PARTS
Earphones, Headphones, Pocket Radios, & Small Bluetooth vSpeakers	\$5.00	1 Year	1 Year
Personal Stereos	\$10.00	1 Year	1 Year
Portable Radio/Cassette	\$15.00	1 Year	1 Year
Large Portable Radio Cassette	\$20.00	1 Year	1 Year
Mobile Audio	\$10.00	1 Year	1 Year
Pro Audio SBX Systems	\$75.00	1 Year	1 Year
Pro Audio PBX Systems	\$75.00	1 Year	1 Year
Televisions	\$25.00	1 Year	1 Year
Telephones	\$10.00	1 Year	1 Year

THE WARRANTY AND REMEDY PROVIDED ABOVE ARE EXCLUSIVE AND IN LIEU OF ALL OTHER EXPRESSED OR IMPLIED WARRANTIES INCLUDING, BUT NOT LIMITED TO, THE IMPLIED WARRANTIES OF MERCHANTABILITY, NON-INFRINGEMENT OR FITNESS FOR A PARTICULAR PURPOSE. SOME LAWS DO NOT ALLOW THE EXCLUSION OF IMPLIED WARRANTIES. IF THESE LAWS APPLY, THEN ALL EXPRESSED OR IMPLIED WARRANTIES ARE LIMITED TO THE WARRANTY PERIOD IDENTIFIED ABOVE. UNLESS STATED HEREIN, ANY STATEMENT OR REPRESENTATIONS MADE BY ANY OTHER PERSONS OR FIRM ARE VOID, EXCEPT AS PROVIDED IN THIS WRITTEN WARRANTY. QFX SHALL NOT BE LIABLE FOR ANY LOSS, INCONVENIENCE, OR DAMAGE, INCLUDING DIRECT, SPECIAL, INCIDENTAL OR CONSEQUENTIAL DAMAGES, RESULTING FROM THE USE OR INABILITY TO USE THE QFX PRODUCT, WHETHER RESULTING FROM BREACH OF WARRANTY OR ANY OTHER LEGAL THEORY.

Some jurisdictions do not allow limitations on how long an implied warranty lasts, and some jurisdictions do not allow the exclusion or limitation of incidental or consequential damages, so the above limitations and exclusions may not apply to you. This warranty gives you special legal rights and you may have other rights which vary from jurisdiction to jurisdiction.

Copyright Protected 2021 ©



www.qfxusa.com



THANK YOU.

Enjoy your speaker and make many memories with it because
QFX is Where the Party Begins!

We would love to hear about your FX-203 Journey!
Tag us **@QFXUSA** to share your stories.